



Burris

PRODUCT CATALOG

2023

WHITE RIVER

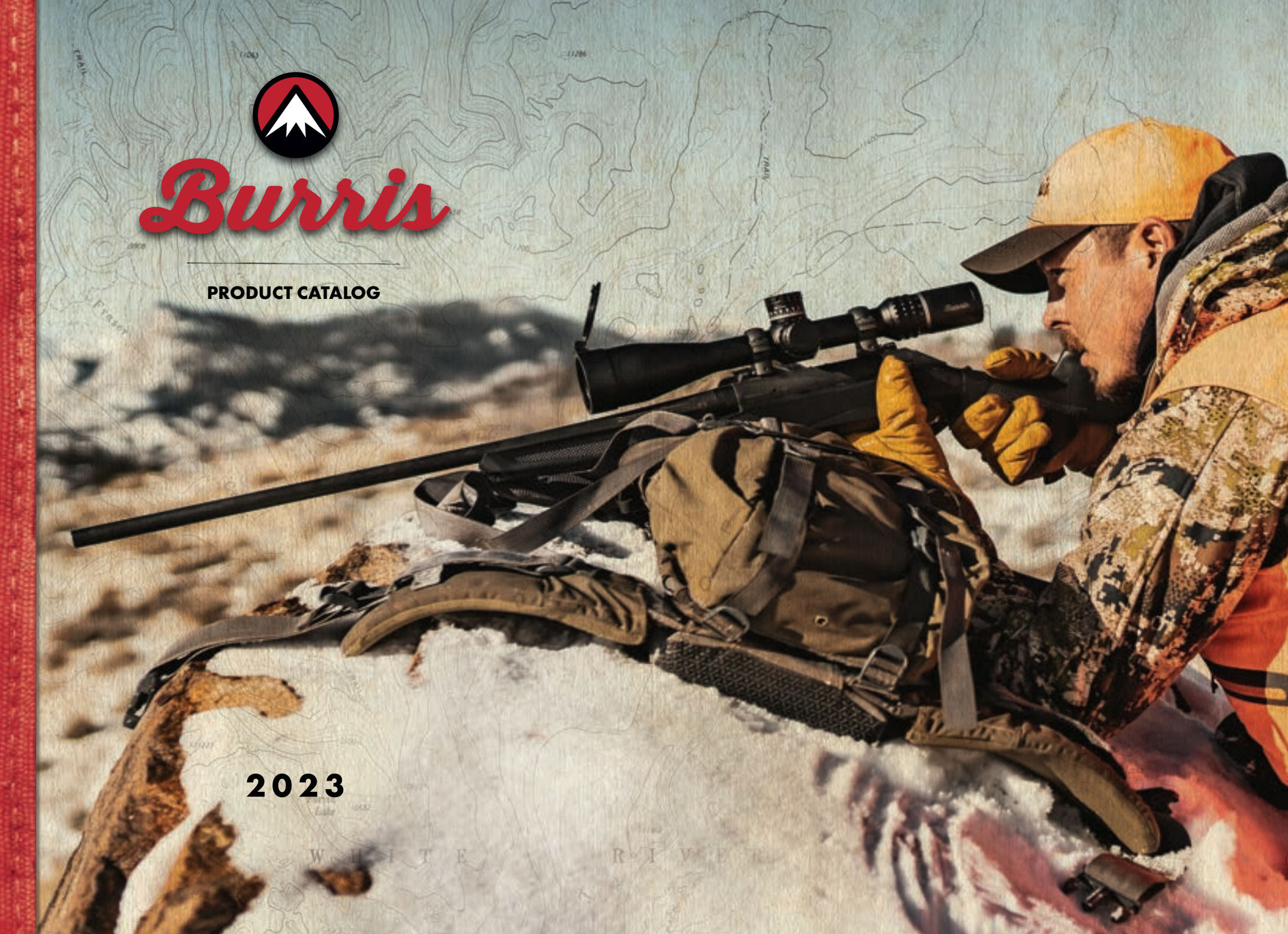

TABLE OF CONTENTS

2023 NEW PRODUCTS

BURRISCONNECT	3
BURRIS LASERSIGHT TECHNOLOGY	4
BALLISTIC SERVICES	6
HUNTING	7
ELIMINATOR® LASERSCOPIES®	8
VERACITY™ RIFLESCOPES	10
SIGNATURE HD™ RIFLESCOPES	14
FULLFIELD IV™ RIFLESCOPES	16
FULLFIELD E1™ RIFLESCOPES	17
DROPTINE™ RIFLESCOPES	18
SCOUT RIFLESCOPES	20
HANDGUN SCOPES	21
RANGEFINDERS	24
BINOCULARS	26
SIGNATURE HD™ SPOTTING SCOPE	27
ORACLE 2 BOWSIGHT	30
ORACLE X BOWSIGHT	31
SPEEDBEAD™ SHOTGUN MOUNT	32
SPEEDBEAD VENT RIB MOUNT	33
TACTICAL	34
XTR PRO™ RIFLESCOPES	36
XTR III™ RIFLESCOPES	38
RT SERIES	40
FASTFIRE™	44
RINGS & MOUNTS	48
WARRANTY AND CUSTOMER SERVICE	54

NEW VERACITY PH

Page 8

Years of development and pushing the limits of what is possible in a rifle optic has led up to this moment. Introducing the VeracityPH from Burris, the perfect combination of reliability, quality, and technology delivering the fastest and most precise aiming solution in a hunting optic, ever. Dial to distance with confidence and let Burris do the math.



PĒK

Programmable Elevation Knob

Featuring the new Burris PĒK (Programmable Elevation Knob) System the Veracity PH takes speed and precision to the highest level.



NEW SIGNATURE LRF 2000

Page 24

The perfect companion for your Burris rifle scope, the Signature LRF 2000 redefines speed in a rangefinder. Quickly range targets from 5 to 2400 yards using, sport, hunting, or auto range modes, or scan the field with instant ranging using scan mode. 7x magnification and HD glass makes finding targets easy.

NEW SIGNATURE LRF 10X42MM

Page 25

Well known for integrating powerful rangefinders into optics, Burris introduces the Signature 10x42 LRF binocular for fast and precise ranging from 5 to 2600 yards. Ultrasharp HD glass and an easy-to-read display offer comfortable glassing and blazing fast ranging for both hunters and shooters.



Burris

BURRISCONNECT

MOBILE APP

A ballistics powerhouse at your fingertips, the BurrisConnect app was built to be the solution for operating the Veracity PH, sharing media from Burris Thermal and the go to ballistics tool for hunting and shooting enthusiasts.

Ever evolving, BurrisConnect offers the latest in bullet data to build dope cards, reticle maps, Eliminator data tables, and custom rifle profiles.

Download BurrisConnect and you will have a Download BurrisConnect and you will have a Download BurrisConnect.



SCAN HERE FOR
BURRIS CONNECT
FREE DOWNLOAD



BURRIS BALLISTIC SERVICES 2.0

BALLISTICS.BURRISOPTICS.COM

The newly updated Burris Ballistic Services is a set of sophisticated online ballistic tools that will allow you to master any Burris ballistic compensating reticle, build a dope card, program your Eliminator rifle scope, or order custom elevation knobs. Burris Ballistic Services will turn you into a reticle expert and a pro on the shooting range.



BALLISTIC SERVICES

BurrisOptics.com/Ballistics

BALLISTIC RETICLE ANALYSIS CALCULATOR

Burris offers a wide variety of reticles, and this tool ensures you can utilize their full potential.



Ballistic Plex™



Ballistic Mil-Dot



Ballistic Plex E1™ FFP Varmint



XTR II Ballistic 5.56 Gen 3



Ballistic CQ™

STEP 2
Select Ammunition Type

Factory Load Hand Load

Factory Ammo Details

Select Ammunition Manufacturer: **HORNADY**

Select Cartridge: **5.5 CREEDMOOR**

Select Bullet Weight/Style/Type/Description:

- 5.56 Hornady - 55 Grain BT Lead
- 5.56 Hornady - 55 Grain BT Lead
- 5.56 Hornady - 55 Grain BT Lead
- 5.56 Hornady - 55 Grain BT Lead
- 5.56 Hornady - 55 Grain BT Lead
- 5.56 Hornady - 55 Grain BT Lead
- 5.56 Hornady - 55 Grain BT Lead
- 5.56 Hornady - 55 Grain BT Lead
- 5.56 Hornady - 55 Grain BT Lead
- 5.56 Hornady - 55 Grain BT Lead

Bullet Velocity: Ballistic Coefficient:

BULLET LIBRARY

Ballistics really begin with your bullet. The better the bullet info, the better your results. The Burris Ballistic Services tools are centered around the best bullet and cartridge libraries in the business: almost 7,000 different cartridges and bullets are included from nearly every manufacturer.



DOPE CARD

The Dope Card tool was designed with the serious shooter in mind, but it's also a great way for anyone to learn more about long-range shooting. The Burris Dope Card tool provides a level of detail that goes beyond the vast majority of ballistic tools available now.





ELIMINATOR LASER RIFLESCOPE

The Eliminator LaserScope requires basic programming to work correctly. Using our industry-leading bullet library and ballistic engine, you can now quickly get the ballistic information needed to program your Eliminator scope.

CUSTOM SERVICES AND TECHNICAL HELP

The Burris Custom Shop can help you upgrade the knobs and reticles on many of our riflescopes. Prices will vary depending upon the model and upgrade desired. Here are some approximate costs:

- Knob upgrades start at \$40
- Custom MAD knobs start at \$50
- Reticle changes start at \$60

For specific costs and ordering, call the Technical Support line at **888-440-0244**.



M.A.D. SYSTEM

The Modular Adjustment Dial (M.A.D.) System lets you choose from exposed competition-style knobs or capped knobs for windage and elevation adjustments.

You can also add custom knobs with laser-etched markings that perfectly match the trajectory of any ammunition.

The following configurations are possible in the M.A.D. System:

- Capped knobs with Mil or MOA markings
- Exposed knobs with Mil or MOA markings
- Capped knobs with custom trajectory markings
- Exposed knobs with custom trajectory markings

Shooters will be able to order custom knobs through Burris Customer Service at <https://ballistics.burrisoptics.com/>

		ELEVATION DIAL		WINDAGE DIAL	
		Exposed (non-M.A.D.)	Race Dial	Low Capped	Low Exposed
XTR III					
201200	3.3-18x50mm	•	•	•	•
201201	3.3-18x50mm	•	•	•	•
201202	3.3-18x50mm	•	•	•	•
201210	5.5-28x56mm	•	•	•	•
201211	5.5-28x56mm	•	•	•	•
201212	5.5-28x56mm	•	•	•	•
XTR II		M.A.D. Capped	M.A.D. Exposed	M.A.D. Capped	M.A.D. Exposed
201018	1-8x24mm	•	•	•	•
201019	1-8x24mm	•	•	•	•
VERACITY		M.A.D. Capped	M.A.D. Exposed	M.A.D. Capped	M.A.D. Exposed
200621	2-10x42mm	•	•	•	•
200636	3-15x50mm	•	•	•	•
200641	4-20x50mm	•	•	•	•
200651	5-25x50mm	•	•	•	•
200652	5-25x50mm	•	•	•	•

- Installed on scope
- Packaged with scope
- Optional - contact for purchase

CUSTOM KNOBS

Burris now offers custom knobs for most of our riflescopes. This function allows you to modify the elevation knob to match your exact cartridge and environmental shooting conditions.

The following list of Burris riflescopes can accept custom knobs and options can be ordered using the Custom Knob tool:

- AR RIFLESCOPES
- C4 PLUS
- DROPTINE
- FULLFIELD E1
- MSR RIFLESCOPES
- PREDATOR QUEST
- VERACITY
- XTR II







TRUST US WITH YOUR HUNT

Finding corners of the world still devoid of a cell signal. The relationships solidified while hanging a trophy in camp. The laughter around the campfire as the last flame hangs on. Those familiar with Burris know well what matters. It's about self-reliance. Respect for the game and those you hunt beside. Pushing yourself season after season to be your absolute best. For more than 40 years we've been right there with you, pushing ourselves for the same reasons: we know exactly how much the season means to us, and that's why you can forever trust your hunt to Burris.



Burris

THE LEADER IN LASERSIGHT TECHNOLOGY



Burris Eliminator — the original laser rangefinding scope and still the best in its class. Compared to similar scopes, it's simple and easy to use. There are no apps to download, or additional gear to fumble with. You'll never miss a shot. Just find your target, range and shoot. The new Eliminator IV offers more performance with extended range and enhanced ballistic software.

THE NEXT GENERATION OF THE BURRIS ELIMINATOR

The **new Eliminator IV** significantly extends the range and accuracy of your favorite rifle. With ranging capability out to 2,000 yards, it greatly increases the distance at which you can make an ethical shot. A new onboard ballistics calculator offers more data and faster aiming solutions. Bluetooth laser activation has been added to make it easy to range your target. With a trophy in sight, there's no need to fumble with smart phones and hand-held range finders. Just aim, range and shoot. It's that simple.



Bluetooth Remote

WINDAGE COMPENSATION In addition to distance, the scope's digital display will show a 10 mph Wind Value for your specific cartridge at the indicated range to your target.



Example 300 yards | 10-mph crosswind
shooter holds .9 dots into the wind



Example 500 yards | 10-mph crosswind
shooter holds 1.7 dots into the wind

SEE THE ELIMINATOR
IN ACTION
WATCH THE VIDEO AT
BURRISOPTICS.COM/ELIMINATOR

FOUR TOOLS IN ONE ADVANCED OPTIC!



Precision
Optic



Digital
Inclinometer



Smart
Dope Card



Laser
Range Finder

The Burris Eliminator family of riflescopes are unlike any other scope. Combining four tools into one advanced optic. Eliminating problems, so you can focus on the shot.

- **Precision Optic.** All lenses are fully multi-coated for sharp, crisp, edge-to-edge clarity
- **Digital Inclinometer.** An internal inclinometer delivers a precise aiming point for angled shots up to 45°
- **Smart Dope Card.** Simply program your cartridge and load into the Eliminator. The precise holdover is automatically determined
- **Laser Range Finder.** The built-in laser rangefinder will instantly determine the distance to your target out to 2,000 yards



Burris ELIMINATOR™

RIFLESCOPES



Wireless Bluetooth remote for laser activation

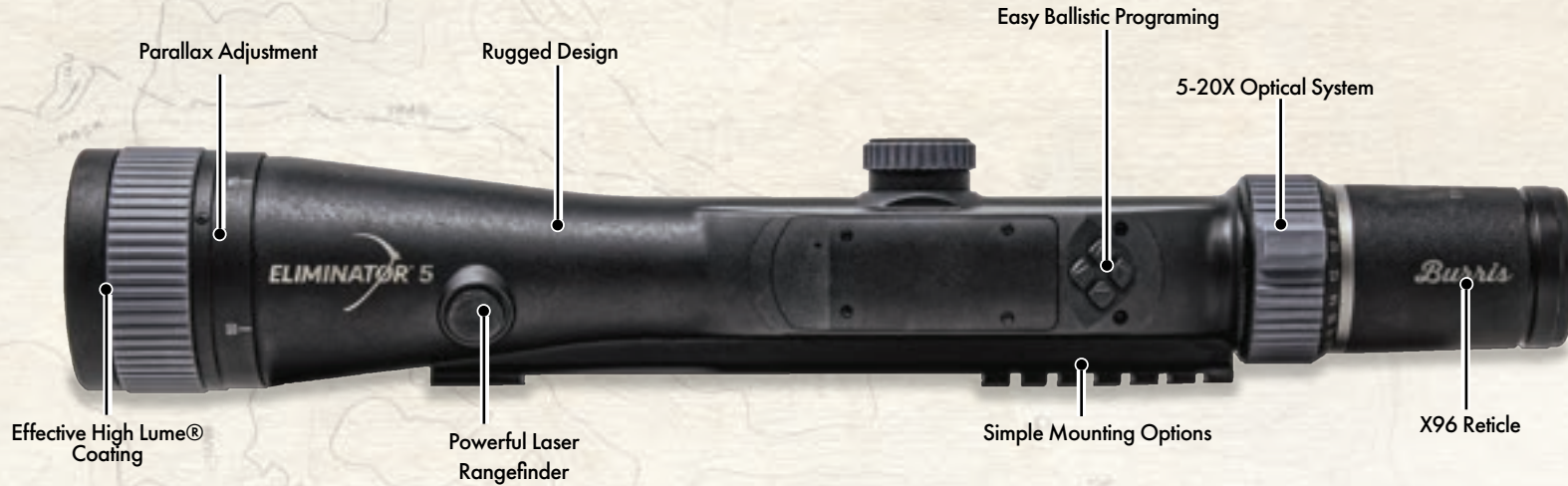

Parallax Adjustment

Rugged Design

Easy Ballistic Programming

5-20X Optical System

Effective High Lume® Coating

Powerful Laser Rangefinder

Simple Mounting Options

X96 Reticle

ELIMINATOR 5 RIFLESCOPE 5-20x50mm

ITEM NUMBER:
200155

RETICLE:
X96 RETICLE

ADJUSTABLE PARALLAX:
50 YDS. TO INFINITY

- Powerful laser rangefinder extends your range to 2,000 yards
- Improved ballistics calculator accommodates centerfire, rimfire, muzzleloader and slug gun loads
- Wireless Bluetooth remote for laser activation

- Proven X96 reticle displays a 10-mph wind value to indicate wind hold-off for your specific cartridge at the indicated range
- Mounts to any Weaver-style or Picatinny base. No rings required
- Index-matched, Hi-Lume® multi-coating aids in low-light performance and glare elimination

ELIMINATOR 4 RIFLESCOPE 4-16x50mm

ITEM NUMBER:
200133

RETICLE:
X96 RETICLE

ADJUSTABLE PARALLAX:
50 YDS. TO INFINITY



WATERPROOF



SHOCKPROOF



FOGPROOF



NITROGEN-FILLED



Two words: no guesswork. It's plug and play in a rangefinding scope that goes even bigger: Just feed the Eliminator 5 your cartridge's ballistic info and the scope calculates perfect holdover at your exact distance, estimates wind drift, then gives you a bright red dot of accuracy in seconds—all at the push of a button.



Burris

VERACITY™

RIFLESCOPES

Years of development and pushing the limits of what is possible in a rifle optic has led up to this moment. Introducing the Veracity PH from Burris, the perfect combination of reliability, quality, and technology delivering the fastest and most precise aiming solution in a hunting optic, ever. Dial to distance with confidence and let Burris do the math.

PĒK

(Programmable Elevation Knob)



NEW VERACITY PH RIFLESCOPE 4-20x50mm

ITEM NUMBER:
200200

RETICLE:
WIND MOA FFP RETICLE

ADJUSTABLE PARALLAX:
50 YDS. TO INFINITY

- PĒK (Programmable Elevation Knob)
- Built-In Heads Up Display
- Custom Ballistic Information, in Yards, Meters or MOA
- Burris Mobile App and Bluetooth Connectivity
- Digital Bubble Level displays rifle cant
- Customizable windage holdover



WATERPROOF



SHOCKPROOF



FOGPROOF



NITROGEN-FILLED



VERACITY SERIES FEATURES

- Our top-of-the-line hunting scopes featuring a 5x zoom system, a larger field of view and front focal plane design
- Front focal plane reticle allows the reticle size to increase or decrease with magnification so trajectory compensation is always correct for the selected power setting
- Advanced windage and elevation adjustment is accurate and repeatable, and matches the reticle's MOA measurement system



VERACITY RIFLESCOPE 2-10x42mm

ITEM NUMBER:
200621 (M.A.D.)

RETICLE:
BALLISTIC PLEX E1™ FFP

MAIN TUBE SIZE: **30 mm**

ITEM NUMBER:
200622 (M.A.D.)

RETICLE:
BALLISTIC E2™ RFP

ADJUSTABLE SIDE PARALLAX: **50 YDS. TO INFINITY**

- Low-profile adjustment knobs are finger-adjustable for windage and elevation; easily indexed to zero once sighted in.



VERACITY RIFLESCOPE 4-20x50mm

ITEM NUMBER:
200640

RETICLE:
BALLISTIC PLEX E1™ FFP VARMINT

ADJUSTABLE SIDE PARALLAX:
50 YDS. TO INFINITY

ITEM NUMBER:
200641 (M.A.D.)

RETICLE:
BALLISTIC PLEX E1™ FFP

- Designed for precise adjustment at extreme ranges, perfect for varmint hunting; multi-turn target knobs offer up to 15 MOA of adjustment per rotation
- 50 mm objective allows for maximum light transmission
- Ergonomic side focus allows easy-to-reach parallax adjustment
- Zero Click Stop adjustment knobs allow quick, easy return to original sight-in setting without counting rotations

RETICLES

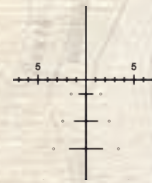

Ballistic
E2™ RFP



Ballistic Plex
E1™ FFP



Ballistic Plex
E1™ FFP Varmint



SCR™ MOA



VERACITY RIFLESCOPE 3-15x50mm

ITEM NUMBER:
200636 (M.A.D.)

RETICLE:
BALLISTIC PLEX E1™ FFP

MAIN TUBE SIZE: **30 mm**

ITEM NUMBER:
200638 (M.A.D.)

RETICLE:
BALLISTIC E2™ RFP

ADJUSTABLE SIDE PARALLAX: **50 YDS. TO INFINITY**

- Low-profile adjustment knobs are finger-adjustable for windage and elevation; easily indexed to zero once sighted in.
- 50 mm objective allows for maximum light transmission



VERACITY RIFLESCOPE 5-25x50mm

ITEM NUMBERS:
200650

RETICLE:
BALLISTIC PLEX E1™ FFP VARMINT

MAIN TUBE SIZE: **30 mm**

ITEM NUMBER:
200651 (M.A.D.)

RETICLE:
BALLISTIC PLEX E1™ FFP

ADJUSTABLE SIDE PARALLAX: **50 YDS. TO INFINITY**

ITEM NUMBER:
200652 (M.A.D.)

RETICLE:
SCR™ MOA

- Designed for precise adjustment at extreme ranges, perfect for varmint hunting; MAD knobs offer 24.5 MOA of adjustment in one rotation
- 50 mm objective allows for maximum light transmission
- Ergonomic side focus allows easy-to-reach parallax adjustment
- Zero Click Stop adjustment knobs allow quick, easy return to sight-in yardage setting without counting rotations

Burrís

SIGNATURE HD™

RIFLESCOPES

When you're ready to step up, the Signature HD is the right choice. Designed to make the most of your experience, with the precise features, reticles, reliability and ease of use that seasoned hunters like you demand -- and the monsters you're after can't escape.



SIGNATURE HD RIFLESCOPE 5-25x50mm

ITEM NUMBERS:
200533
RETICLE:
BALLISTIC E3™
ILLUMINATED

ITEM NUMBERS:
200534
RETICLE:
FINE PLEX™

ITEM NUMBERS:
200535
RETICLE:
6.5 CM™
ILLUMINATED

- Great choice for NRL 22 precision rimfire matches
- Available with dedicated 6.5 Creedmoor reticle
- Zero stop turrets

MAIN TUBE SIZE: 30 mm



WATERPROOF



SHOCKPROOF



FOGPROOF



NITROGEN-FILLED





RETICLES

SIGNATURE HD SERIES FEATURES

- 5x zoom system with premium, multi-coated glass for crisp, bright images.
- New push/pull locking turrets.
- Available with a wide choice of front and rear focal plane reticles.
- Side parallax adjustment on most models.
- Zero stop feature on all target knobs.



SIGNATURE HD RIFLESCOPE 3-15x44mm

ITEM NUMBERS:
200531

RETICLE:
**BALLISTIC E3™
ILLUMINATED**

ITEM NUMBERS:
200532

RETICLE:
PLEX™

- Mid-range scope in hunting and target models (low and high knobs)
- Choice of illuminated or non-illuminated MOA reticles



MAIN TUBE SIZE: 1 in.

SIGNATURE HD RIFLESCOPE 2-10x40mm

ITEM NUMBERS:
200530

RETICLE:
BALLISTIC E3™

- Versatile scope that's perfect for rimfire, centerfire and muzzle loader rifles
- Ballistic E3 reticle provides a simple method for determining holdover for distance and hold-off for wind drift



MAIN TUBE SIZE: 1 in.

Burrís

FULLFIELD IV™

RIFLESCOPES



On any hunt, there's
a few things you can
count on. Wary game.

Lousy weather. And
your Fullfield IV scope.

After nearly 50 years of
steady performance and
constant refinement, the
latest Fullfield is the surest
companion a hunter can
have.



FULLFIELD IV RIFLESCOPE 2.5-10x42mm

ITEM NUMBERS:
200485

RETICLE:
BALLISTIC E3™

ITEM NUMBERS:
200486

RETICLE:
**BALLISTIC E3™
ILLUMINATED**

ITEM NUMBERS:
200487

RETICLE:
PLEX™

- Wide field-of-view
- Rugged, lightweight design
- Finger adjustable windage/elevation turrets

MAIN TUBE SIZE: 1 in.



FULLFIELD IV RIFLESCOPE 3-12x56mm

ITEM NUMBERS:
200491

RETICLE:
**BALLISTIC E3™
ILLUMINATED**

MAIN TUBE SIZE: 1 in.

- Large 56mm objective for better light transmission
- Illuminated reticle for low light performance
- 30mm tube offers more adjustment range



WATERPROOF



SHOCKPROOF



FOGPROOF



NITROGEN-FILLED





FULLFIELD IV RIFLESCOPE 3-12x42mm

ITEM NUMBERS:
200488
RETICLE:
LONG RANGE MOA™

ITEM NUMBERS:
200489
RETICLE:
**C4 WIND MOA™
ILLUMINATED**

ITEM NUMBERS:
200490
RETICLE:
BALLISTIC E3™

- Versatile enough for varmint to big game
- Choice of three ballistic plex reticles



MAIN TUBE SIZE: 1 in.

FULLFIELD IV RIFLESCOPE 4-16x50mm

ITEM NUMBERS:
200492
RETICLE:
**BALLISTIC E3™
ILLUMINATED**

ITEM NUMBERS:
200493
RETICLE:
6.5 CM™

ITEM NUMBERS:
200494
RETICLE:
**LONG RANGE MOA™
ILLUMINATED**

- Large 50mm objective for better light transmission
- Available with dedicated 6.5 Creedmoor reticle
- Side parallax adjustment



MAIN TUBE SIZE: 1 in.

FULLFIELD IV RIFLESCOPE 6-24x50mm

ITEM NUMBERS:
200495
RETICLE:
BALLISTIC E3™

ITEM NUMBERS:
200496
RETICLE:
FINE PLEX™

ITEM NUMBERS:
200497
RETICLE:
SCR MOA™

- Ideal for long-range target shooting
- Choice of three precision reticles
- Side parallax adjustment



MAIN TUBE SIZE: 30 mm

FULLFIELD IV SERIES FEATURES

- Improved 4x zoom system with premium, multi-coated lenses for edge-to-edge clarity and low light performance
- Wide selection of reticles for both hunting and long-distance target shooting
- 1" and 30mm tube options
- Sleek new design with finger adjustable turret knobs, adjustable parallax (select models)

RETICLES

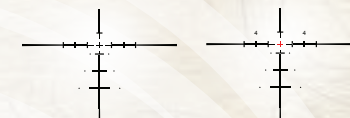

Ballistic E3™

Ballistic E3™
Illuminated



Plex™

Long Range MOA™
Illuminated



C4 Wind MOA™
Illuminated

6.5 CM™



Fine Plex™

SCR MOA™

Burrís

FULLFIELD E1™

RIFLESCOPES



If you had to pick just one scope that defines our DNA, it would be the Fullfield. The original Fullfield and Fullfield E1 represent 50 years of performance and reliability and lots of filled tags.

FULLFIELD E1 SERIES FEATURES

- Choice of ballistic plex reticles. Both MOA and Mil on Fullfield and Ballistic Plex E1™ reticle with trajectory compensation out to 500 yards and cascading dots for crosswinds.
- Finger-adjustable windage and elevation knobs create a sleek profile; knob indications always reflect a change in the point of impact for pinpoint accuracy.



FULLFIELD E1 RIFLESCOPE 6.5-20x50mm

ITEM NUMBER:
200341

RETICLE:
BALLISTIC PLEX E1™ MV

MAIN TUBE SIZE: 1 in. ADJUSTABLE SIDE PARALLAX:
50 YDS. TO INFINITY

- High magnification extends your long-range shooting capability
- Ergonomic side focus allows easy-to-reach parallax adjustment



FULLFIELD E1 RIFLESCOPE 4.5-14x42mm

ITEM NUMBER:
200338

RETICLE:
BALLISTIC PLEX E1™

MAIN TUBE SIZE: 1 in. ADJUSTABLE SIDE PARALLAX:
50 YDS. TO INFINITY

- High magnification extends your long-range shooting capability
- Ergonomic side focus allows easy-to-reach parallax adjustment



FULLFIELD E1 RIFLESCOPE 3-9x40mm

ITEM NUMBERS:
200320

RETICLE:
BALLISTIC PLEX E1™

MAIN TUBE SIZE: 1 in.

- Most popular and versatile model
- Available illuminated reticle has 10 settings from low light to daylight; reduces time to get on target in any lighting condition and increases accuracy when target is dark



Burris

DROPTINE™

RIFLESCOPES



Step into legendary Burris performance with a scope that steps up your game. Our reliable, high-quality glass is glare-resistant and superbly capable in low light, with a shockproof design that gives you the most for your dollar.

DROPTINE RIFLESCOPE 3-9x40mm

ITEM NUMBERS:
200017

RETICLE:
BALLISTIC PLEX™

MAIN TUBE SIZE: 1 in.

- 200017 with focus set at 100 yards for centerfire loads
- 200019 with focus set at 50 yards and calibrated for .22 LR ammo



DROPTINE RIFLESCOPE 4.5-14x42mm

ITEM NUMBERS:
200491

RETICLE:
**BALLISTIC E3™
ILLUMINATED**

MAIN TUBE SIZE: 1 in.

- Large 56mm objective for better light transmission
- Illuminated reticle for low light performance
- 30mm tube offers more adjustment range



WATERPROOF



SHOCKPROOF



FOGPROOF



NITROGEN-FILLED



Burris

SCOUT™

RIFLESCOPES

Specifically designed to match scout rifles, our slim, compact optics give you low-to-medium magnification, perfect for close- to mid-range targets. Placed well forward on the rifle, you'll get—and keep—both eyes perfectly on targets both moving and still. When that happens, well, we all know what goes down next.



RETICLES

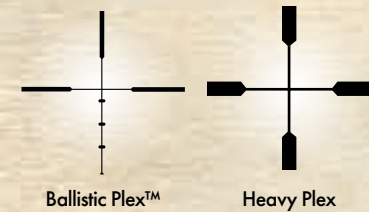

SCOUT RIFLESCOPE 2-7x32mm

ITEM NUMBER:
200261

MAIN TUBE SIZE:
1 in.

RETICLE:
BALLISTIC PLEX™

- Variable power for versatility and improved accuracy at longer distances



SCOUT RIFLESCOPE 2.75x20mm

ITEM NUMBER:
200269

MAIN TUBE SIZE:
1 in.

RETICLE:
HEAVY PLEX

- Fixed 2.75x power, the perfect magnification setting for both-eyes-open scout rifle shooting



SCOUT SERIES FEATURES

- Specifically designed for the multi-purpose scout rifle concept popularized by Col. Jeff Cooper
- Compact and lightweight, so it's easy to carry your rifle in the field
- Forward mounting design allows mounting in front of the ejection port, for extended eye relief and both-eyes-open shooting with unobstructed access to the cartridge port; beneficial for fast target acquisition and increased situational awareness



WATERPROOF



SHOCKPROOF



FOGPROOF



NITROGEN-FILLED



Burris

HANDGUN

SCOPES

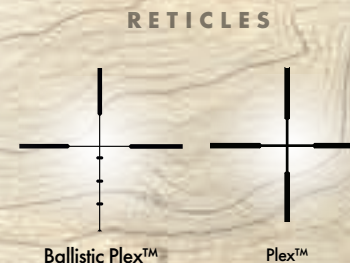

Given handgun hunters employ some seriously impressive cartridges, these durable and reliable scopes are purpose-built with superb recoil absorption and long eye relief appropriate for heavy recoil long range shooting.

HANDGUN SCOPE 2x20mm

ITEM NUMBERS:
200218, 200229

RETICLE:
PLEX

MAIN TUBE SIZE:
1 in.

- Most compact and lightweight configuration in the product line
- Available with matte black (200218) or nickel finish (200229)



HANDGUN SCOPE 2-7x32mm

ITEM NUMBERS:
200279, 200299

RETICLE:
BALLISTIC PLEX™

MAIN TUBE SIZE:
1 in.

ITEM NUMBERS:
200291, 200298

RETICLE:
PLEX

- Variable 2-7x magnification offers greater field versatility
- Available with matte black (200279) or nickel finish (200299)
- Available Posi-Lock™ system (item 200299) uses a retractable steel post in addition to the springs of a conventional adjustment system, to keep the point of aim firmly locked in place.



HANDGUN SCOPE 3-12x32mm

ITEM NUMBER:
200309

RETICLE:
BALLISTIC PLEX™

MAIN TUBE SIZE:
1 in.

- Large magnification extends your long-range shooting capability
- Parallax adjustment for improved accuracy at any distance

ADJUSTABLE PARALLAX:
25 YDS. TO INFINITY



HANDGUN SCOPES FEATURES

- Compact, lightweight scopes with long eye relief create the perfect platform for handgun hunting
- Double internal spring-tension system allows the scope to hold zero through shock, recoil, and vibrations
- Durable, stress-free, solid 1-piece outer tube withstands shock and vibrations of even the heaviest-recoiling calibers
- High-grade optical glass provides excellent brightness and clarity



POSI-LOCK™



OPTICS THAT ENHANCE YOUR HUNT

Well known for integrating powerful rangefinders into optics, Burris introduces the Signature 10x42 LRF binocular for fast and precise ranging from 5 to 2600 yards. Ultrasharp HD glass and an easy-to-read display offer comfortable glassing and blazing fast ranging for both hunters and shooters.



Burris

Burris

SIGNATURE LRF 2000

RANGEFINDER

★★★★★
FOREVER WARRANTY
★ NO QUESTIONS ASKED ★



WATERPROOF



SHOCKPROOF



FOGPROOF



NITROGEN-FILLED

The perfect companion for your Burris riflescope, the Signature LRF 2000 redefines speed in a rangefinder. Quickly range targets from 5 to 2400 yards using, sport, hunting, or auto range modes, or scan the field with instant ranging using scan mode. 7x magnification and HD glass makes finding targets easy.



NEW BURRIS SIGNATURE LRF 2000

ITEM NUMBER:
300351

- Eye safe laser measures targets out to 2,400 yards or 2,194 meters.
- Three ranging modes for maximum precision: Auto, Sport and Hunt.
- Distances can be displayed as line-of-sight or horizontal with angles of degree.
- The Signature LRF 2000 is nitrogen-filled for waterproof, fog proof performance.
- Outer surfaces are rubber armored for protection and a sure grip.
- Adjustable eyepiece ensures a clear view.



Burris

SIGNATURE 10x42 LRF

BINOCULAR

Well known for integrating powerful rangefinders into optics, Burris introduces the Signature 10x42 LRF binocular for fast and precise ranging from 5 to 2600 yards. Ultrasharp HD glass and easy to read display offer comfortable glassing and blazing fast ranging for both hunters and shooters.



★★★★★
FOREVER WARRANTY
★ NO QUESTIONS ASKED ★



WATERPROOF



SHOCKPROOF



FOGPROOF



NITROGEN-FILLED



NEW BURRIS SIGNATURE LRF 10X42 BINOCULAR

ITEM NUMBER:
300299

- Eye safe laser measures targets out to 2,600 yards or 2,377 meters.
- Three ranging modes for greater versatility: Auto, Sport and Hunt
- Distances can be displayed as line-of-sight or horizontal with angles of degree.
- Tripod Adaptable
- Outer surfaces are rubber armored for protection and a sure grip.
- Adjustable eyepiece ensures a clear view.



Burris BINOCULARS™

SIGNATURE HD
& DROPTINE



WATERPROOF



SHOCKPROOF



FOGPROOF



NITROGEN-FILLED

SIGNATURE HD BINOCULARS 8x42mm



ITEM NUMBER:
300292

- 8x magnification and HD glass for optimal light transmission and true color fidelity

SIGNATURE HD BINOCULARS 10x42mm



ITEM NUMBER:
300293

- 10x magnification brings the minute details into focus without additional weight and bulk.

SIGNATURE HD BINOCULARS 12x50mm



ITEM NUMBER:
300294

- 12x magnification is the best choice for wide open country and terrain and larger 50mm objectives offer better detail in low light

SIGNATURE HD SERIES FEATURES

- High-performance HD lenses and BaK-4 prisms produce sharper images and edge-to-edge clarity
- Open bridge design reduces weight and is comfortable to hold
- Nitrogen filled for waterproof and fogproof performance in harsh weather conditions
- Robust aluminum eyecups for extreme ruggedness

DROPTINE BINOCULARS 8x42mm



ITEM NUMBERS:
300290

- 8x magnification provides detail and a wide field-of-view
- Full size performance in compact, light-weight package

DROPTINE BINOCULARS 10x42mm



ITEM NUMBERS:
300291

- 10x magnification is ideal for scouting eastern whitetail or western mule deer

DROPTINE SERIES FEATURES

- BaK-4 prisms and fully multi-coated lenses for maximum light transmission and reduced glare.
- Nitrogen filled for waterproof and fogproof performance in harsh weather conditions
- All Burris binoculars include a durable carrying case and neoprene neck strap for all-day comfort
- Robust aluminum eyecups for extreme ruggedness

NEW DROPTINE HD BINOCULARS 8x42mm



ITEM NUMBERS:
300278

- 8x magnification provides detail and a wide field-of-view
- Full size performance in compact, light-weight package

NEW DROPTINE HD BINOCULARS 10x42mm



ITEM NUMBERS:
300279

- 10x magnification is ideal for scouting eastern whitetail or western mule deer

Burrís

SPOTTER

SIGNATURE HD

★★★★★
FOREVER WARRANTY
 ★ NO QUESTIONS ASKED ★



Take glassing to a higher level with Burris' Signature HD Spotting Scope. With a 20-60x magnification range, you can save time and boot leather by finding and evaluating trophy animals from a mountain away. The HD lenses and apochromatic lens system eliminate color fringing and deliver superb edge-to-edge resolution.

SPOTTER SIGNATURE HD 20-60x85mm

ITEM NUMBER:
300102
 HARD CASE
 ITEM NUMBER:
626205

- Built-in sun shade reduces glare and protects the objective lens from rain and snow
- Both coarse and fine focusing adjustment are possible with the forward mounted focus knob
- Eyecup can be adjusted to accommodate eyeglasses
- Lightweight, durable design with a die-cast magnesium body that is armored for greater protection in the field
- Angled eyepiece and rotating tripod mount makes it easy to use whether you're standing or prone



30x WIDE ANGLE EYEPIECE

ITEM NUMBER :
626201
 RETICLE:
SCR MIL

ITEM NUMBER :
626202
 RETICLE:
SCR MOA

- An optional fixed power 30x eyepiece provides even more range, detail and a wide field-of-view
- Available with your reticle choice of a SCR Mil or SCR MOA
- Easy to install



SERIES FEATURES

- Premium HD glass for optimum resolution and maximum light transmission under any lighting condition
- The index-matched lenses eliminate color aberrations and produce true color fidelity across the visible light spectrum
- Nitrogen gas purging ensures waterproof, fog proof performance under extreme temperatures

RETICLES

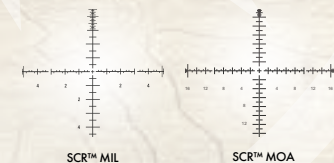



AIM WITH CONFIDENCE

The Oracle X and Oracle 2 are built on a decade of experience with rangefinding optics like the Eliminator Laserscope. At the push of a button the Oracle X and Oracle 2 instantly display the distance to your target and provide the perfect aiming point for your exact set up.



Burris

Burris

ORACLE 2™

BOW SIGHT

★★★★★
FOREVER WARRANTY
 ★ NO QUESTIONS ASKED ★



WATERPROOF



SHOCKPROOF



FOGPROOF

The Oracle 2 improves our original Oracle design with user requested upgrades and enhancements! Eliminate guessing distance with this improved rangefinding bow sight that gives a precise distance to the target at full draw. No more aiming between pins – the Oracle 2 instantly calculates and displays the exact aiming point for the distance and shot angle.

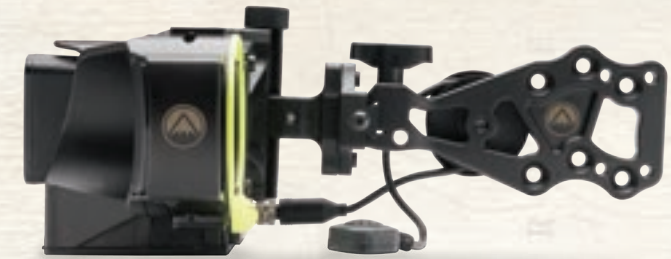

ORACLE 2 RANGEFINDING BOW SIGHT

ITEM NUMBERS:
300401

- Improved accuracy, easier to set up and sight in.
- Works for right- and left-handed shooters.
- Fixed 20-yard pin dead battery fail safe.
- Program up to two different arrows.
- Improved auto-bright detection for LED pins.
- Improved manual brightness control.
- Rugged, all aluminum construction.
- Enhanced Water Resistance.



HOW IT WORKS

- 1 Sight in at 20 yards plus two farther distances and the Oracle 2 learns your arrow's entire trajectory curve.
- 2 Sight in up to 2 additional distances (optional) for extreme long range accuracy.
- 3 The rangefinder measures the exact distance to your target while at full draw.
- 4 It instantly calculates the exact trajectory for the distance and shot angle.
- 5 The sight displays a bright, LED pin at the exact aiming point for your shot.

Burris

ORACLE X™

CROSSBOW SCOPE

The most innovative and technologically advanced crossbow scope available today. Mounted on your crossbow, the built-in laser rangefinder gives an exact distance to your target and provides an exact aiming point. The automatic trajectory compensation eliminates holdover and compensates for both distance and angle.



Oracle XB 124 Reticle



ORACLE X RANGEFINDING CROSSBOW SCOPE

ITEM NUMBERS:
300410

- An integrated inclinometer helps to determine shot placement when shooting at steep angles up or down.
- Program and save up to two bolt profiles to cover lightweight, fast bolts and heavy, high penetration bolts for different hunts.
- Wireless remote
- Water Resistant
- Digital level to reduce unwanted cant.
- Rugged, lightweight composite construction.
- Precise aluminum mount / adjustment system.
- Locking screws to ensure adjustments stay in place.



WATERPROOF



SHOCKPROOF



FOGPROOF

Burrís

SPEEDBEAD™

SHOTGUN MOUNTS



No other system exists for mounting a FastFire™ optic ultra-low and perfectly in line with the natural sighting plane of the shotgun. Improve your speed and accuracy over waterfowl, upland birds, turkeys or clays.

FASTFIRE™ 3 WITH SPEEDBEAD SHOTGUN MOUNT

- Includes both 8-MOA Fastfire 3 red dot sight and SpeedBead Shotgun Mount in one package
- Mounts low between the stock and receiver
- Line of sight falls just above the vented rib for accurate aiming
- 1x magnification allows both-eyes-open shooting
- Parallax free, for improved accuracy
- CR-1632 battery with automatic time-out feature lasts up to 5 years



FastFire™ 3 8-MOA Dot

Item	Compatible with Shotgun
300240	Benelli® Super Black Eagle II
300241	12 Ga. Benelli® M2, Montefeltro, Ultra Light
300253	Beretta® A400 Xplore
300244	Beretta® Xtrema/2, 391, 391 Light, Urika/2
300245	Remington® 870
300248	Remington® 1100, 1187

SPEEDBEAD SHOTGUN MOUNTS

- SpeedBead Shotgun Mount only; FastFire optics sold separately
- Compatible with many popular shotguns
- All SpeedBead Shotgun Mounts are compatible with all FastFire red dot sight models
- Mounts between the stock and receiver



Item	Compatible with Shotgun
410670	Benelli® Super Black Eagle II
410671	Benelli® Super Black Eagle (original) 12ga
410672	Benelli® M2, 12 Ga., Montefeltro, Ultra Light
410673	Benelli® M1, 12 Ga.
410674	Benelli® Legacy 12 Ga., Sport II, Super Sport, Cordoba
410687	Benelli® M2 20 Ga.
410677	Beretta® A400 Xplore
410678	Speed Bead, Beretta Xtrema/2, 391, 391 Light, Urika/2
410679	Franchi® I-12
410680	Remington® 870
410681	Remington® 1100, 1187

Item	Compatible with Shotgun
410686	Remington® Versa Max
410683	Stoeger® 3500
410684	Winchester® SX3; Browning® Gold 12 Gauge
410685	Browning® Maxus 12 Gauge

Item	Description
410355	SpeedBead Mount Riser – 1/8 in.
410356	SpeedBead Mount Riser – 1/4 in.

Windage and elevation adjustments let you fine-tune your aiming point to the center of your shot pattern.

SpeedBead mount installs between the buttstock and receiver; works with any shim kit.

SpeedBead mount aligns the red dot lower than any other optic on the market for accurate and instinctive shooting.

Burris SPEEDBEAD™

SHOTGUN VENT RIB MOUNT

NEW SPEEDBEAD SHOTGUN VENT RIB MOUNT

ITEM NUMBERS:
410688

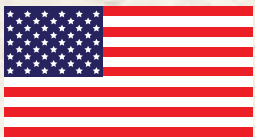
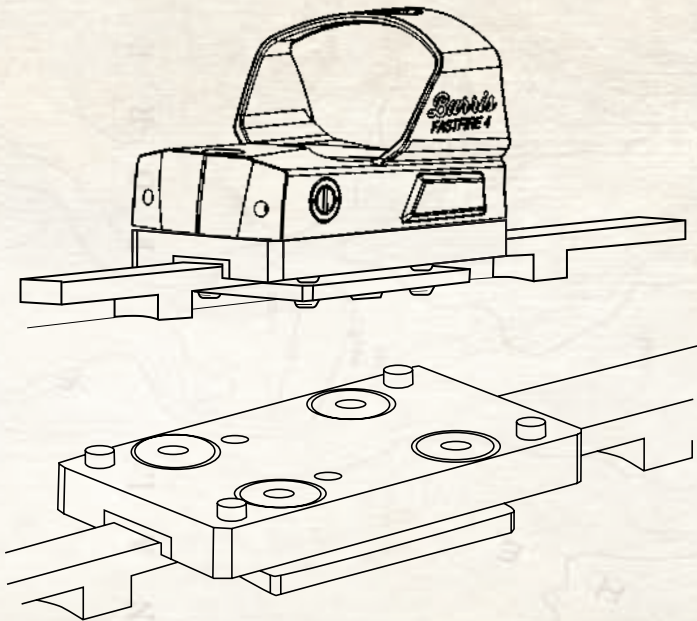

Proudly designed,
machined
and assembled in the
USA.



- No drilling and tapping required.
- Rib adapters included to fit multiple rib widths.
- Red-dot is always centered to the rib and gun when mounted, with no play left or right.
- Mount provides complete rib capture, side-to-side and for full length of the mount.
- Easier target acquisition.
- Black anodized aluminum won't damage the finish on your gun.





WHEN THERE'S FAR TOO MUCH ON THE LINE

Whether it's in the face of a threat or in heated competition, no tolerance exists for failure. There's far too much on the line, and that requires unfailing certainty and faith that your optics will help you perform and prevail when it's go time. Knowing you—and we—have done everything in our power to help that shot find its mark is what matters above all, and that starts with the name you'll see right there on your scope.

That name is Burris.



Burris

XTR PRO™

RIFLESCOPES

Our best competition riflescope ever, the XTR Pro once again raises the bar. Designed and manufactured in Greeley, Colorado, this next-generation long-range competition optic puts you on target at extreme ranges with innovation only Burris can provide. Outpace the competition with exclusive features including the Burris Race Dial and new Tool-less Zero Click Stop Elevation Knob, and achieve better accuracy with three reticle options and best-in-class optical clarity.



Tool-less Zero Click Stop
Elevation Knob

XTR PRO™ 5.5-30x56mm

ITEM NUMBERS:
300621

- **Tool-less Zero Click Stop Elevation Knob:** Allows the shooter to quickly and easily adjust the zero-click stop without any tools
- **The Burris Race Dial:** Elevation turret features a "whiteboard" style coating. Using a wet or dry erase marker, shooters can mark each target's click value on a given stage
- At 30x this new optical system provides greater depth of field, sharper images, better resolution, and a larger eye box than competitive scopes



Proudly designed,
machined
and assembled in the
USA.

RETICLES

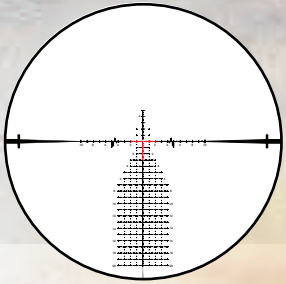

SCR 2

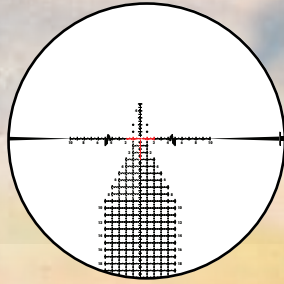

SCR 2 1/4 mil

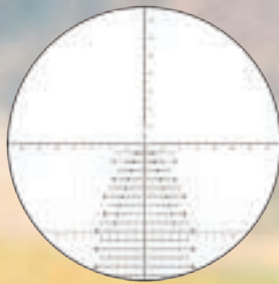

HORUS
TREMOR 5



★ ★ ★ ★ ★
FOREVER WARRANTY
★ NO QUESTIONS ASKED ★



WATERPROOF



SHOCKPROOF



FOGPROOF



NITROGEN-FILLED

Burrís

XTR III™

RIFLESCOPE

★★★★★
FOREVER WARRANTY
 ★ NO QUESTIONS ASKED ★



WATERPROOF



SHOCKPROOF



FOGPROOF



NITROGEN-FILLED

A Colorado original. Engineered and designed out West where distance is measured in hours instead of yards. This next generation long-range competition puts you on target at extreme ranges with Best-In-Class features such as an industry best field of view, 5x plus zoom range, choice of three front focal plane reticles, race dial options and more.



XTR III RIFLESCOPE 5.5-30x56mm

ITEM NUMBER:
201213
 (-Illuminated)

RETICLE:
SCR MOA

MAIN TUBE SIZE:
34 MM

ITEM NUMBER:
201214
 (Illuminated)

RETICLE:
SCR2 MIL

ADJUSTABLE SIDE PARALLAX:
20 YDS. TO INFINITY

- At 30x this new optical system provides greater depth of field, sharper images, better resolution and larger eye box than competitive scopes
- 56mm front objective delivers brighter images at high magnification under any light condition



XTR III RIFLESCOPE 3.3-18x50mm

ITEM NUMBER:
201203
(Illuminated)

ITEM NUMBER:
201204
(Illuminated)

RETICLE:
SCR MOA

RETICLE:
SCR2 MIL

- Choose from three reticles to match your shooting style. With over 120 MOA in elevation adjustment, it will reach out past a mile with the 6.5 Creedmoor
- The shorter overall length balances well with any shooting platform

MAIN TUBE SIZE:
34 MM

ADJUSTABLE SIDE PARALLAX:
25 YDS. TO INFINITY

SERIES FEATURES

- 34mm Body tube for extended adjustment range
- 5x+ Zoom with 150° power ring rotation
- Improved optical system with a larger field of view, smaller eyepiece signature and generous eye box at all magnifications
- Oversize tactical knobs with a Race Dial option for PRS and NRL style shooting
- Three reticle options in MIL or MOA
- Zero click stop for dependability



RETICLES

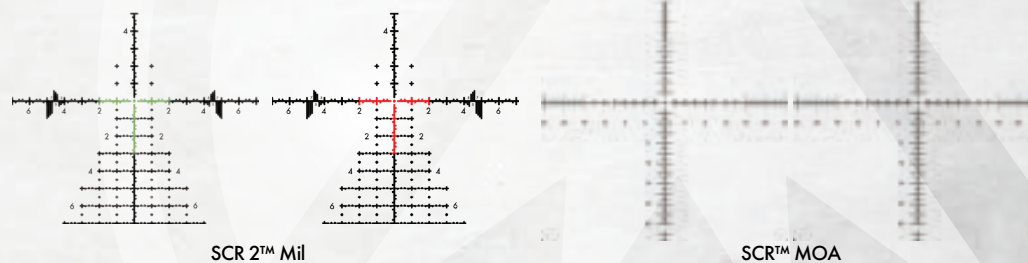

WATERPROOF



SHOCKPROOF



FOGPROOF



NITROGEN-FILLED

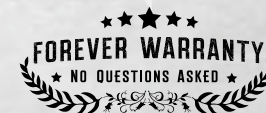

Burris

RT™

SERIES

★★★★★
FOREVER WARRANTY
 ★ NO QUESTIONS ASKED ★



WATERPROOF



SHOCKPROOF



FOGPROOF



NITROGEN-FILLED

The Burris RT line of Red Dot and Prism Sights are designed for tactical and competition shooters.

Constructed of a one-piece aluminum body, each RT is compact, lightweight, and rugged. The RT-3 and RT-5 provide 3X and 5X magnification respectively with Ballistic reticles providing fine aiming lines for elevation, windage, and holdover compensation.

The RT-1 features a 2 MOA red dot at true 1X magnification for precise shooting even with both eyes open.

RT-1

ITEM NUMBERS:
300261

RETICLE:
2 MOA DOT

- Compact, durable construction
- True 1x magnification
- Longer Battery Life
- Comes with high and low base mounts



2 MOA Dot

RT-3

ITEM NUMBERS:
300262

RETICLE:
BALLISTIC 3X™

- Smaller footprint and lighter weight for better balance
- 3x Magnification
- Longer Battery Life
- Larger field-of-view for quick target acquisition
- Integrated Picatinny mount for optimum height



Ballistic 3X™

RT-5

ITEM NUMBERS:
300263

RETICLE:
BALLISTIC 5X™

- 5x Magnification
- Longer Battery Life
- Larger field-of-view for quick target acquisition
- Integrated Picatinny mount for optimum height



Ballistic 5X™



RT-6 RIFLESCOPE 1-6x24mm

ITEM NUMBERS:
200472,
200475 (COMBO)

RETICLE:
BALLISTIC AR™

- Illuminated reticle with 11 levels of illumination
- Integrated adjustable throw lever
- Available in matte black

SERIES FEATURES

- The RT Series was designed for competition and tactical shooting
- Choice of 1x, 5x and 6x zoom ranges for every need from close to long-range
- Ballistic AR™ and SCR 2 mil reticles with trajectory compensation out to 600 yards
- All scopes feature an integrated adjustable throw lever can be located anywhere on the power ring for a customized fit



Ballistic AR™

The 1-6x zoom starts at a true 1x, for both-eyes-wide-open target acquisition. The 6x top end will get you out past 600 yards. The Ballistic AR mil reticle combines a very fast target-acquisition center with trajectory compensation for distance shots.



Available as a Tactical Combo Kit (200475)



WATERPROOF



SHOCKPROOF



FOGPROOF



NITROGEN-FILLED

Burris

RT™

SERIES

What's your shooting style—precision rifle competition, NRL 22 rimfire, 3-gun or weekends at the range? Step up your game without breaking the bank with Burris RT-25 and RT-15 riflescopes. RT scopes feature an integrated adjustable throw lever that can be placed anywhere on the power ring for quick and custom focus selection.



★★★★★
FOREVER WARRANTY
★ NO QUESTIONS ASKED ★



WATERPROOF



SHOCKPROOF



FOGPROOF



NITROGEN-FILLED

RT-25 RIFLESCOPE 5-25x56mm

ITEM NUMBERS:
200481

RETICLE:
SCR 2 MIL™

MAIN TUBE SIZE:
30 mm

- Side parallax adjustment
- Front Focal Plane SCR 2 Mil reticle with 1/10 Mil adjustments
- 80 MOA total elevation travel
- Zero click stop on adjustments



RT-15 RIFLESCOPE 3-15x50mm

ITEM NUMBERS:
200480

RETICLE:
SCR 2 MIL™

MAIN TUBE SIZE:
30 mm

- Side parallax adjustment
- Front Focal Plane SCR 2 Mil reticle with 1/10 Mil adjustments
- 65 MOA total elevation travel
- Zero click stop on adjustments



RETICLES

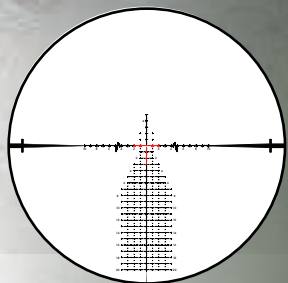

SCR 2

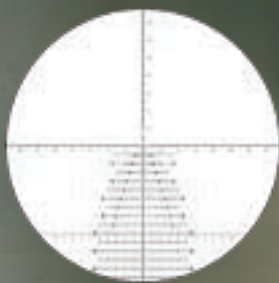

HORUS
TREMOR 5



WATERPROOF



SHOCKPROOF



FOGPROOF



NITROGEN-FILLED

Burris

FASTFIRE™

RED DOT SIGHTS

★★★★★
FOREVER WARRANTY
 ★ NO QUESTIONS ASKED ★



WATERPROOF



SHOCKPROOF



Instant dot-on-target accuracy for any firearm from handgun to shotgun, any sport from 3-Gun to wing shooting, any use from patrol to plinking. Loads of reticle options, massive battery life and 4 different models make FastFire the most versatile red dot reflex you can mount.

FASTFIRE 4

ITEM NUMBERS:
300259

RETICLE:
MULTI-RETICLE

- Toggle between four different reticles
- Impact resistant housing
- Brighter aiming point with longer battery life
- Bigger sight window for faster target acquisition
- Removable weather shield stays attached when slide mounted.



FASTFIRE 3

ITEM NUMBERS:
300234

DOT SIZE:
3 MOA

ITEM NUMBERS:
300236

DOT SIZE:
8 MOA

- Automatic brightness sensor adjusts brightness to match the environmental conditions; also has 3 manual brightness settings
- Battery access is conveniently located on the top of the sight; automatic time-out feature after 8 hours helps battery last up to 5 years
- Available with Picatinny/Weaver mount for mounting on rifles, handguns and tactical shotguns





AR-F3™

ITEM NUMBER:
300215

DOT SIZE:
3 MOA

ITEM NUMBER:
410348
MOUNT ONLY

- Product includes AR-F3 tactical mount and 3-MOA FastFire 3 red dot sight
- Positions the FastFire at the optimum height on an AR as a standalone sight and as a co-witness for iron sights
- Sight is protected by metal wings on each side
- Has convenient storage space for spare battery, open-end wrench, and Torx® wrench
- Fits any Weaver or Picatinny-style base

SERIES FEATURES

- Bright red dot allows for fast target acquisition and easy aiming
- 1x magnification allows for both-eyes-open shooting, for enhanced awareness and target acquisition
- Parallax-free, for better accuracy
- Mounts to almost anything—including handguns, rifles and shotguns—and the shockproof design stands up to years of punishing recoil
- Windage and elevation adjustments make fine-tuning easy

MOUNTS

Item	Mount
410321	1911 Standard
410322	1911 Adjustable/Novak
410323	Kimber® Standard/Target/Bomar
410324	Beretta® 92 & 96/90Two/Cougar/Taurus PT99
410319	Glock 45 ACP & 10mm, + PX4 Storm
410327	Sig Sauer® P226
410328	Springfield XD®
410336	Smith & Wesson® M&P®
410318	Ruger American Pistol
410329	Ruger® Mark I, II, III
410332	Ruger® M77, No. 1, Super Redhawk, Super Blakhawk Hunter
410333	Marlin® 336, 444, 1895 (Pre-drilled and tapped)
410334	Winchester® M94 (Pre-drilled and tapped)
410335	Picatinny/Weaver
410635	Sako® Rifles (Requires Picatinny Mount # 410335)

NEW FASTFIRE RD

ITEM NUMBERS: **300260** DOT SIZE:
2 MOA

- FastFire RD (Rifle Dot) features a 2 MOA red dot
- Brighter dot with longer battery life
- Fits Weaver-style/Picatinny rails
- Rugged alloy housing is impact resistant



PICATINNY PROTECTOR MOUNT

ITEM NUMBER:
410330

- Protects FastFire I, II, and III from impact or abuse
- Use when mounting a FastFire on pistols, rifles or shotguns, for extra protection and peace of mind
- Fits Weaver or Picatinny-style base

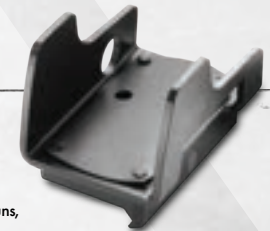

RED DOT

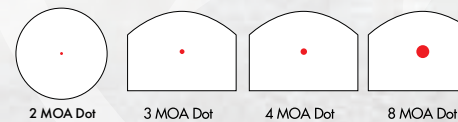

2 MOA Dot 3 MOA Dot 4 MOA Dot 8 MOA Dot

FASTFIRE 4 RETICLES



3 MOA 11 MOA 11 MOA and Circle 3 MOA, Circle & Wings





SOLID FOUNDATION FOR SUCCESS

Burris has built a reputation for some of the most solid, reliable rings and bases on the market. Our quality rings, mounts and accessories create the perfect shooting solution. You'll stay on target round after round with gear from Burris.



Burris

Burris

RINGS & MOUNTS

Hunters and tactical shooters count on Burris mounting solutions, with a wide variety of options that securely mount a rifle scope onto any Weaver or Picatinny-style rail. These rings and bases provide long-lasting holding power and durability for hunters, duty officers and competitive shooters.



**AR-P.E.P.R.
Quick-Detach
Model**



AR-SIGNATURE QD™ P.E.P.R.™ MOUNTS

- The new streamlined design with QD mount insures ¼ MOA re-mount capability and allows for use of back up iron sights while maintaining proper eye-relief. Available in 30-, 34- and 35-mm options with Burris' Signature polymer ring inserts, it provides adjustment from 5 to 40 MOA without using windage/elevation knobs.

AR-P.E.P.R.™ MOUNTS

- Full ring and base mounting solution in one
- Allows up to 2 inches of forward scope positioning
- Provides optimum eye relief and full field of view
- Includes both smooth and Picatinny ring tops
- Quick-detach models allow for fast mounting

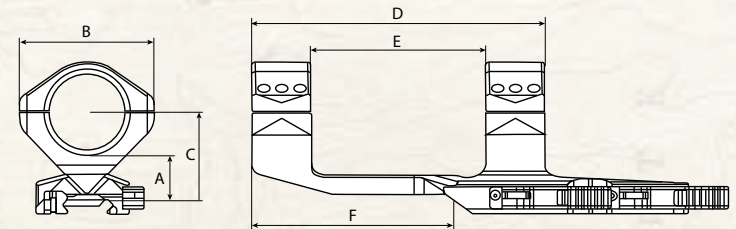
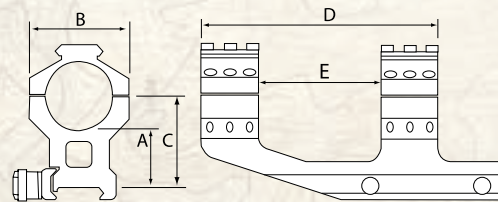

Item	Size	Weight	Dimensions					QD MOUNT	CANT
			A	B	C	D	E		
410341	30 mm	8.7 oz.	1.00 in.	1.75 in.	1.60 in.	4.15 in.	2.15 in.		0 MOA
410342	30 mm	8.7 oz.	1.00 in.	1.75 in.	1.60 in.	4.15 in.	2.15 in.	•	0 MOA
410343	1 in.	8.3 oz.	1.00 in.	1.57 in.	1.50 in.	4.15 in.	2.15 in.		0 MOA
410344	1 in.	8.3 oz.	1.00 in.	1.57 in.	1.50 in.	4.15 in.	2.15 in.	•	0 MOA
410345	34 mm	6.9 oz.	0.68 in.	1.90 in.	1.35 in.	4.90 in.	2.90 in.		20 MOA

Item	Size	Weight	Dimensions						QD MOUNT
			A	B	C	D	E	F	
410352	30 mm	10.33 oz.	.81 in.	2.13 in.	1.5 in.	5.0 in.	3.0 in.	3.45 in.	•
410353	34 mm	10.09 oz.	.76 in.	2.28 in.	1.5 in.	5.0 in.	3.0 in.	3.45 in.	•
410354	35 mm	10.09 oz.	.76 in.	2.28 in.	1.5 in.	5.0 in.	3.0 in.	3.45 in.	•



XTR RINGS™

- 1 in. and 30 mm models are lightweight aluminum with incredible holding power
- Quick-detach models allow fast mounting

Item	Size	Quick-Detach	Aluminum	Steel	1 Ring	2-Ring Set
Low						
420160	30 mm		•			•
420161	30 mm		•		•	
420180	1 in.		•			•
Medium						
420162	30 mm		•			•
420163	30 mm		•		•	
420181	1 in.		•			•
High						
420164	30 mm		•			•
420165	30 mm		•		•	
420182	1 in.		•			•
Extra-High						
420166	30 mm		•			•
420167	30 mm		•		•	
420183	1 in.		•			•

Picatinny Ring Top - allows attachment of accessories on top of mounted scope

420169	30 mm		•		•	
--------	-------	--	---	--	---	--



Low



Extra-High



Picatinny Ring Top



XTR SIGNATURE RINGS™

- Provide precision customization of cant to maximize usable elevation adjustment of the scope. Included inserts allow for 5, 10, 15, 20, 25, 30 and 40 MOA of cant
- Provide 100% scope-to-ring contact, eliminating the need to lap rings while providing tremendous gripping power without leaving ring marks
- Strong, lightweight aluminum rings feature solid steel dual screw clamps that insure each ring mounts flat and centered on any Picatinny base
- Includes the following Pos-Align® Offset Inserts: Concentric (Zero MOA), +/-5 MOA, +/-10 MOA, and +/-20 MOA (2 sets)

RING HEIGHTS

These are the dimensions of XTR Signature Rings, from the center of the scope to the top of the mount base.

Item	Height	Size	Item	Height	Size
420210	1.00 in.	34 mm	420223	1.50 in.	30 mm
420211	1.50 in.	34 mm	420231	1.00 in.	1 in.
420221	1.00 in.	30 mm	420232	1.25 in.	1 in.
420222	1.25 in.	30 mm	420233	1.50 in.	1 in.

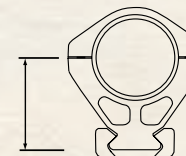

RING HEIGHTS

These are the dimensions of Xtreme Tactical Rings, from the center of the scope to the top of the mount base.

	Low	Medium	High	Extra-High
30 mm	0.85 in.	1.10 in.	1.35 in.	1.60 in.
1 in.	0.75 in.	1.00 in.	1.25 in.	1.50 in.

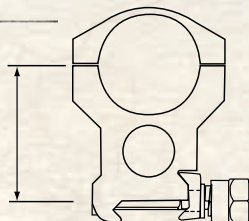

1/2-INCH PICATINNY RISER

- Provides 1/2 inch of additional mounting height for optimal sight alignment on tactical platforms

Item	Height	Length
410340	0.5 in.	1.5 in.



Burris RINGS & MOUNTS



Signature Universal Dovetail Rings

Item	Size	Height	Finish
Signature Universal Dovetail			
420501	1 in.	Medium	Matte
420511	1 in.	High	Matte
420578*	30 mm	Medium	Matte
420581*	30 mm	High	Matte
420582*	30 mm	Extra-High	Matte
Signature Double Dovetail			
420561	1 in.	Medium	Matte

*30 mm comes with "zero" inserts and +/- .010 inserts for both front and rear rings.

SIGNATURE RINGS

- Revolutionary Pos-Align® Inserts technology
- Pos-Align Inserts guarantee perfect centering and maximum scope-to-ring contact for tremendous gripping power without damaging the scope finish
- Lets you virtually sight in your gun without moving the scope adjustments
- Corrects misalignment caused by off-center receiver holes
- Corrects for bases or rings being slightly off-center
- No need for expensive tapered bases or shimming for thousand-yard shooting
- Solid steel rings are ideal for hunting

Signature Zee Rings

Item	Size	Height	Finish
Signature Zee Rings (Weaver-Style)			
420520	1 in.	Medium	Black Gloss
420521	1 in.	Medium	Matte
420522	1 in.	Medium	Nickel
420530	1 in.	High	Black Gloss
420531	1 in.	High	Matte
420532	1 in.	High	Nickel
420585*	30 mm	Extra-High	Matte
420587*	30 mm	High	Matte
420588*	30 mm	Medium	Matte

Signature Rimfire/Airgun Rings

Item	Size	Height	Finish
Signature Rimfire/Airgun			
420554	1 in.	Medium	Matte
420556	1 in.	High	Matte

Comes with clamps for 11 mm and 3/8" dovetails

Pos-Align® Offset Inserts

Signature Pos-Align® Offset Inserts	
Installation Kit	
626019	1 each of +/- .005, +/- .010, +/- .020
Gunsmith Kit	
626024	10 each of +/- .005, +/- .010, +/- .020
Individual Inserts	
626017	+/- .010 Eccentric Offset
626018	+/- .020 Eccentric Offset

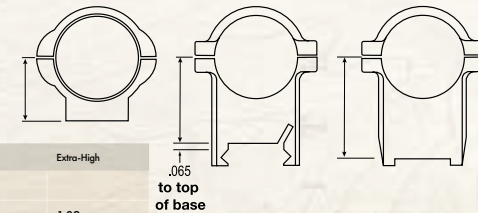

RING HEIGHTS

Ring Heights	Low	Medium	High	Extra-High
Signature 1 In.		0.77	0.89	
Signature 30 mm		0.78	0.89	1.02
Zee Signature 1 In.		0.77	0.92	
.22 Signature Deluxe		0.90	1.29	
Zee Signature 30 mm		0.81	0.93	1.18

Dimensions listed are from the center line of the scope tube to the bottom of the ring.



ZEE RINGS

- Tough, solid steel
- Weaver-style
- Machined to exacting tolerances to handle recoil or abuse

Item	Size	Height	Finish	Quick-Detach
Weaver-Style				
420031	1 in.	Low	Matte	•
420034	1 in.	Medium	Matte	•
420037	1 in.	High	Matte	•
420044	30 mm	Medium	Matte	
420077	30 mm	High	Matte	
420079	1 in.	Low	Nickel	
420080	1 in.	Low	Black Gloss	
420081	1 in.	Medium	Black Gloss	
420082	1 in.	High	Black Gloss	
420083	1 in.	Low	Matte	
420084	1 in.	Medium	Matte	
420085	1 in.	Medium	Nickel	
420086	1 in.	High	Nickel	
420087	1 in.	High	Matte	



Zee Ring, Standard Model

Zee Ring, Quick-Detach Model

RIMFIRE/AIRGUN RINGS

- Available in solid steel or aluminum
- Securely mount your rimfire or airgun optic

Item	Size	Height	Finish	Material	Quick-Detach
.22 Ring Pairs (fits in 22-in. grooved receivers)					
420069	1 in.	Medium	Matte	Steel	
420072	1 in.	Medium	Black Gloss	Steel	
420073	1 in.	High	Black Gloss	Steel	
420076	1 in.	High	Matte	Steel	
420068	1 in.	Medium	Matte	Steel	•



CZ-STYLE RINGS

- Solid steel
- Designed for mounting optics on CZ rifles

Item	Size	Height	Finish	Action
CZ 550				
420130	1 in.	Medium	Matte	Long-Action
CZ 527				
420140	1 in.	Medium	Matte	Short-Action



TIKKA® T3® RINGS

- Solid steel
- Ring and base solution specifically designed for Tikka® T3® rifle

Item	Size	Height	Finish
Tikka T3 Rings			
420135	1 in.	Medium	Matte
420136	30 mm	Medium	Matte
420137	30 mm	High	Matte

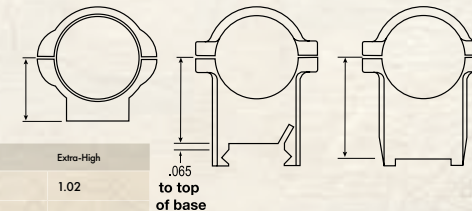

RING HEIGHTS

Ring Heights	Low	Medium	High	Extra-High
Standard 30 mm		0.78	0.89	1.02
Zee 1 in. & Quick-Detach 1 in.	0.63	0.76	0.95	
Zee 30 mm		0.81	0.93	1.18
CZ (All)		1.00		
1-in. .22 Rings (All)		0.80	0.95	
Tikka T3		1.125	1.250	

Dimensions listed are from the center line of the scope tube to the bottom of the ring.

Burris

RINGS & MOUNTS

XTREME TACTICAL™ 2-PIECE BASES

- Solid steel bases work with all Weaver-style, Picatinny-style, and mil-spec rings
- Engineered with minimal height and weight
- Mil-spec cross slots guarantee rock-solid attachment
- Matte finish



Item	Style	Reversible Front Base
410600	XTB-700/7 (Remington® 700 & 7 Short & Long)	•
410605	XTB-70/Express (Winchester® 70 Short, Long & Express)	•
410606	XTB-70 WSS (Winchester® 70 Short, Long & SXR)	•
410615	XTB-SavR (Savage® Short & Long Round Rear)	•
410620	XTB-SavF (Savage® Short & Long Flat Rear)	•
410625	XTB-ABOLT (Browning® A-Bolt Short & Long)	•
410630	XTB-TIKKA® (Tikka®)	•
410635	XTB-SAKO® Dovetail (SAKO® Dovetail Steel Base Low Profile)	

RUGER®-TO-WEAVER BASE ADAPTER

- For use with Zee Rings
- Mounts optics onto Ruger® firearms that feature the proprietary Ruger® integral mounting system



Item	Compatible with Ruger® Firearm
410990	M77®, Super Redhawk®
410991	No. 1, 77/22®, 77ML®, 77/44®, Mini-14®, Redhawk®
410992	M77® for use with Eliminator® LaserScope®

XTREME TACTICAL™ 1 PIECE BASES

The new Xtreme Tactical one-piece bases offer the perfect mounting solution for precision shooters. In addition to greater strength and rigidity, the 25 MOA cant offers extended range capability.

- Milled from a single piece of solid steel
- Compatible with all Weaver-style, Picatinny-style rings
- Designed to work with both short and long actions
- Matte finish



Item	Style	MOA Cant
410650	XTB-Sav Round Rear Long	25
410651	XTB-Sav Round Rear Short	25
410652	XTB-700 Long Action - Howa 1500 Long Action	25
410653	XTB-700 Short Action	25
410655	XTB-Howa 1500 Short Action	25
410658	XTB-TIKKA® (Tikka®)	25
410660	XTB-Sav Round Rear Long	No Cant
410661	XTB-Sav Round Rear Short	No Cant
410662	XTB-700 Long Action - Howa 1500 Long Action	No Cant
410663	XTB-700 Short Action	No Cant
410665	XTB-Howa 1500 Short Action	No Cant
410668	XTB-TIKKA® (Tikka®)	No Cant





BURRIS FOREVER WARRANTY™

Every Burris optic is covered by the Burris Forever Warranty™. We will repair or replace your Burris optic if it is damaged or defective. The warranty is automatically transferred to future owners.

- No repair or replacement charge
- No questions asked
- No warranty card needed
- No receipt needed



LEGAL INFORMATION

The following are trademarks of Burris Company, Inc.: AR Riflescopes™, AR RifleScope™, AR-1X™, AR-332™, AR-536™, AR-F3™, AR-P.E.P.R.™, AR-Pivot Ring™, Quick Detach, AR-Tripler™, Ballistic CQ™, Ballistic CQ™-1X, Ballistic Mil-Dot, Ballistic Plex E1™, Ballistic Plex E1™ FFP, Ballistic Plex E1™ FFP Varmint, Ballistic Plex E1™ MV, Ballistic Plex™, Ballistic AR™, Ballistic Circle Dot™, Ballistic Dot™, Burris®, C4 Plus™, C4 Wind MOA™, Double Dovetail™, Droptine™, Electro-Dot™, Eliminator® III LaserScope® Series, FastFire™ II, FastFire™ III, FastFire™, Forever Warranty™, FourX™, Fullfield E1™, Fullfield II™, Fullfield TAC30™, G2B Mil-Dot™, High Country™, HiLume™, Horus® H591™, Long-Range MOA, LRS™, MSR Riflescopes™, MTAC™, Oracle™, Pos-Align® Inserts, Posi-Lock™, PTC™, Ruger®-to-Weaver Base Adapter, Scope Tube FastFire™ Mounts, SCR™, SCR™ Mil, SCR™ MOA, Signature Rings™, SkullTac™, SpeedBead™, StormCoat™, T.M.P.R.™, Timberline™, Veracity™, WindMap™, XTB™, XTR II™, XTR III™, XTR Signature Rings™, Signature HD™, Xtreme Tactical™ Bases, Xtreme Tactical™ Rings, XTS-2575™.

The following firearm brand and model names are registered trademarks of their respective owners: Benelli Super Black Eagle, Super Black Eagle II, M1, M2, Montefeltro, Ultra Light, Super Nova, R1, ARGO, Legacy, Sport II, Super Sport, Cordoba; Beretta 92, 96, 90-TWO, Cougar, PX4 Storm; Browning Silver Auto, Maxus, Gold; Franchi I-12; Glock; Marlin 336, 444, 1895. Remington 870, 1100, 1187; Sig Sauer P226; Smith & Wesson M&P; Springfield XD; Stoeger 2000, P-350, 3500. Winchester SX3, M94. CZ is a registered trademark of CZ-USA. Franchi is a registered trademark of Franchi S.P.A. Kimber is a registered trademark of Kimber Mfg., Inc. 10/22, 77/22, 77/17, 77/44, 77/ML, Blackhawk, Mark I, Mark II, Mark III, Mini-14, M77, Redhawk, Ruger, Ruger No. 1, Super Blackhawk Hunter, and Super Redhawk are registered trademarks of Sturm, Ruger & Co., Inc. Marlin is a registered trademark of Remington Arms Company, LLC. Smith & Wesson is a registered trademark of Smith & Wesson Corp. Taurus is a registered trademark of Forjas Taurus S.A.

Tikka is a registered trademark of Sako Ltd., Corp. Torx is a registered trademark of Textron Inc. Leupold is a registered trademark of Leupold & Stevens, Inc. Predator Quest is a registered trademark of Predator Quest, LLC. Realtree Max-1® is a registered trademark of Jordan Outdoor Enterprises, Ltd.

Horus® H591™ is a registered trademark of Horus Vision, LLC produced upon license from Horus Vision, LLC and may be covered by pending or issued patents or may have certain limitations. Please visit Horus Vision, LLC's website for more information: www.horusvision.com.

Burris products are protected by one U.S. Patents: burrisoptics.com/patents.

All prices and specifications are subject to change without notice.

© Copyright 2023 Burris Company

Burris GEAR

Style up with the latest Burris apparel and give yourself the performance edge with these quality Burris accessories.

**VISIT OUR NEW ONLINE STORE TO FIND THE LATEST
BURRIS BRANDED ITEMS!**

WWW.BURRISOPTICS.COM

CUSTOMER SERVICE

REPAIRS

For product support of warranty service go to <https://burris.supportsync.com>

BALLISTICS SERVICES

Utilize our world-class bullet library to match your loads with Burris reticles, create DOPE cards, get your Eliminator drop numbers, pair with Veracity PH and Burris Thermal Handhelds. burrisoptics.com/ballistics

PRODUCT MANUALS

Download Burris Optics product manuals at burrisoptics.com/customer-service/manuals.

FAQS

Find answers to common Burris Optics questions at burrisoptics.com/customer-service/faqs.

REBATES, PROMOTIONS AND NEW PRODUCTS

Sign up to receive emails about rebates, promotions and brand new products. Go to burrisoptics.com/email-subscription.



Burris

BURRIS COMPANY
331 E. 8TH STREET
GREELEY, COLORADO 80631
PHONE: 1-888-440-0244
WWW.BURRISOPTICS.COM

© 2023 Burris Company. All rights reserved.
Burris Company is owned by Beretta Holding S.p.A.